

QUICK INSTALLATION GUIDE <G024-8617>

Please read the Safety Information in the "Operating Instructions" before using this machine. It contains important information related to USER SAFETY and PREVENTING EQUIPMENT PROBLEMS.

1 UNPACKING THE PRINTER AND CHECKING THE CONTENTS OF THE BOX

- ⚠ Caution**
- To prevent injury, it is recommended that at least two people are used to lift the printer.

1 Check the contents of the box according to the following list.

- Quick Installation Guide (this sheet)
- Operating Instructions
- CD-ROM

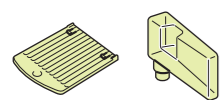

- Output Tray Extender
- Fuser Oil Bottle
- Power Cord
- Additional Documentation

If one or more items are missing, please contact your sales or service representative.

Important

- The interface cable is not included in the box. It is your responsibility to provide the interface cable appropriate for the computer that you are using. For more information on the interface cable, see "9. CONNECTING THE PRINTER TO A COMPUTER".

2 Remove the plastic bag.

3 Lift the printer and move it to the place where you want to install it.

When lifting the printer, use the inset grips on both sides of the printer.

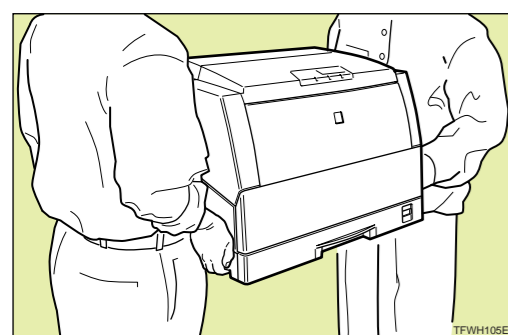

Important

- Be careful to lift the printer as the right front side of the printer is significantly heavier than the left front side.

2 WHERE TO PUT YOUR PRINTER

1 Your printer's location should be carefully chosen because environmental conditions greatly affect its performance.

Warning

- Make sure that the wall socket is near the machine and freely accessible, so that in the event of an emergency, it can be easily unplugged.
- Only connect the machine to the power source described on this sheet.
- Avoid multi-wiring.
- Do not damage, break or make any modifications to the power cord. Do not place heavy objects on it, pull it hard or bend it more than necessary. These actions could cause an electric shock or fire.

Caution

- Keep the machine away from humidity and dust. A fire or an electric shock might occur.
- Place the machine on a strong and level surface. Otherwise, the machine might fall and cause personal injury.
- If you use the machine in a confined space, make sure there is a continuous flow of air.

Optimum Environmental Conditions

The machine must be level within 5 mm, 0.2" both front to rear and left to right.

The recommended temperature and humidity

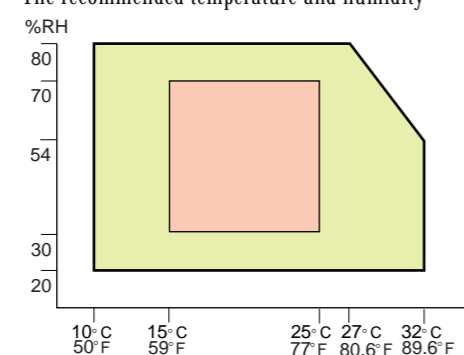

Legend: Possible operation range Recommended range

To avoid possible build-up of ozone, make sure to locate this machine in a large well ventilated room that has an air turnover more than 30m³/hr/person.

If you use this printer in a cold area, leave the printer on. Otherwise, severe cold might damage sensitive components inside the printer.

Space Required for Installing the Printer

Leave enough space around the printer. This space is necessary to operate the printer. The recommended (or minimum) space requirements are as follows:

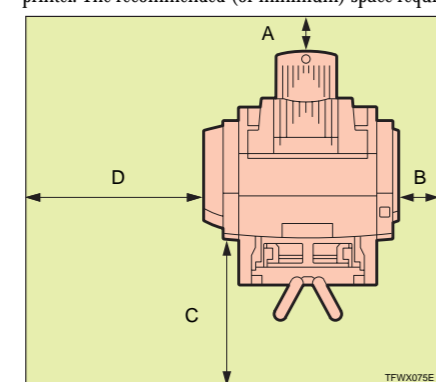

A: more than 5 cm (2.0")

B: more than 10 cm (4.0")

C: more than 70 cm (27.6")

D: more than 65 cm (25.6")

2 Environments to Avoid

Important

- Locations exposed to direct sunlight or strong light
- Dusty areas
- Areas with corrosive gases
- Areas excessively cold, hot, or humid
- Locations near an air conditioner or humidifier
- Locations near other electronic equipment
- Locations where the printer might be subjected to frequent strong vibration

3 Power Connection

Connect the power cord to a power source with a following specifications:

- 120V, 60Hz, 10A or more

3 REMOVING THE TAPES, PROTECTIVE SHEET AND PADDING FROM THE PRINTER

1 Remove the tape that hold the outside covers closed. (There are 10 pieces of tape).

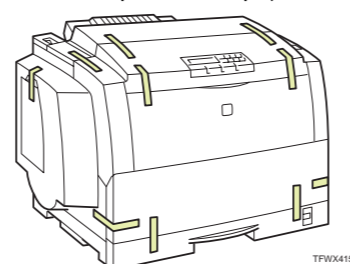

2 Open the front cover by pushing the front cover release button.

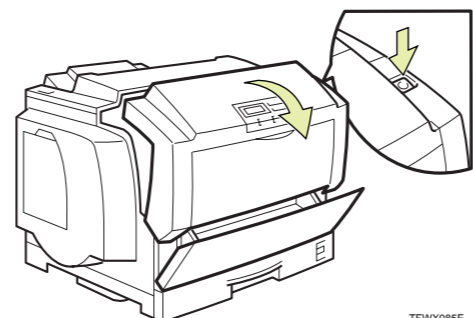

3 Hold the inset grips (green part) of the photoconductor unit, and pull the top side of the photoconductor unit forward.

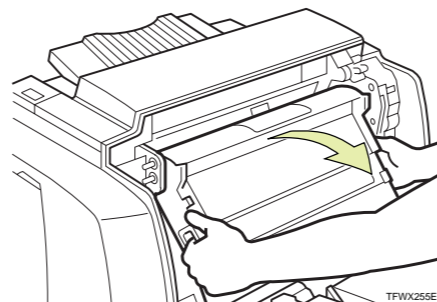

4 Remove the protective sheet by pulling the red tab from the new photoconductor unit.

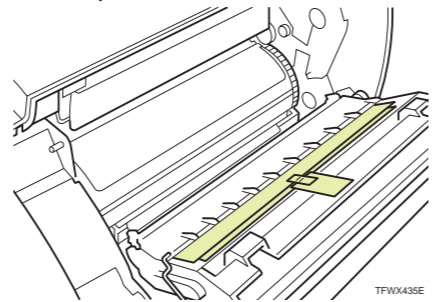

Important

- The condition of the photoconductor unit belt directly affects output appearance and quality. Always be careful to prevent the green film in this unit from becoming dirty or damaged. And do not touch the black belt.
- Do not rotate the gear on the right side of the printer. Otherwise, the inside belt gets damaged.

5 Remove the padding by pulling the red tab. It is located inside the printer on the left side.

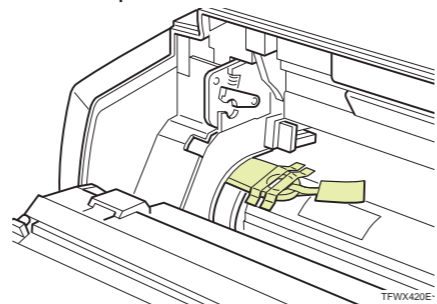

6 Hold the inset grips (green part) of the photoconductor unit, and push the photoconductor unit to its original position.

7 Close the front cover.

Make sure that the front cover close properly.

4 INSTALLING THE FUSER OIL BOTTLE

Caution

- Do not incinerate the oil bottle. This action could cause a fire or getting burned.

Caution

- Spilt oil is very slippery. If oil is spilt, wipe it with alkaline cleaner. Otherwise, the oily surfaces can create the danger of slipping and personal injury.

1 Remove the green cap from the new oil bottle.

Important

- Hold the clear cap while turning the green cap. Do not remove the clear cap.

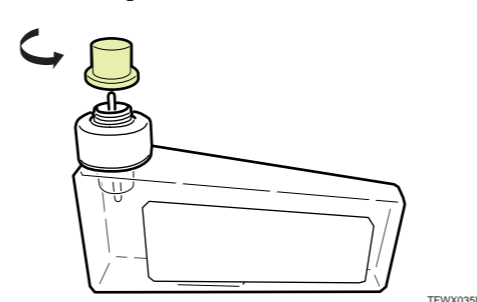

2 Open the fuser oil bottle cover of the printer.

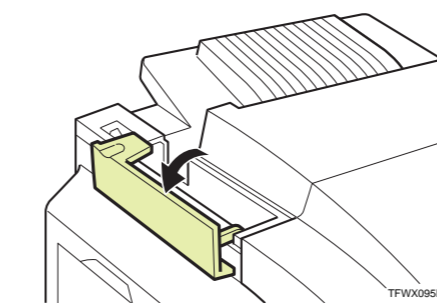

3 Insert the new oil bottle into the oil bottle case.

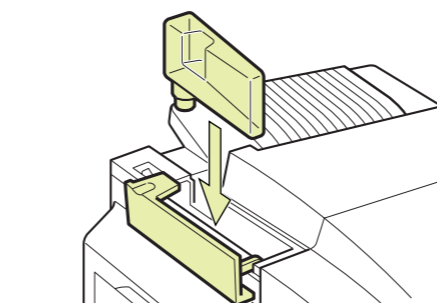

4 Close the fuser oil bottle cover.

5 INSTALLING THE PAPER TRAY AND OUTPUT TRAY EXTENDER

Follow the steps below to load 8 1/2 "x11" (Letter). See "Paper Types and Sizes" in the "Operating Instructions" for details on supported paper types and sizes.

1 Pull the paper tray out of the printer. Place it on a flat surface.

2 Remove the padding (there is one piece) and tape (there are two pieces of tape).

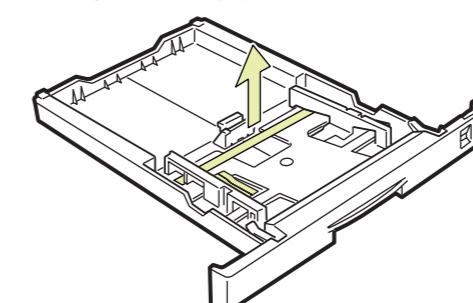

3 Slide the paper guides to position that match the size of paper you want to load.

Adjust the paper guides until they click into position.

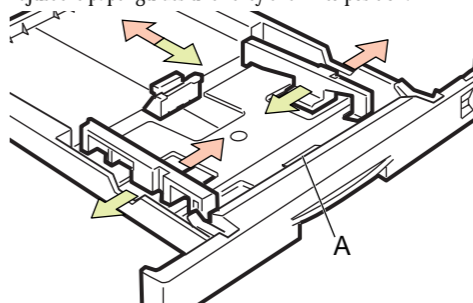

Label A points to the friction pad.

Important

- Do not touch the friction pad (A). Otherwise, paper misfeeds or multi-feeds of paper might occur.

Note

- The factory default setting is 8 1/2 "x11" (Letter).

6 CONNECTING THE POWER CORD

Caution

- It is dangerous to handle the plug with wet hands. Doing this may result in receiving an electric shock.

1 Make sure that the printer's power switch is turned off. If it is on, turn it off.

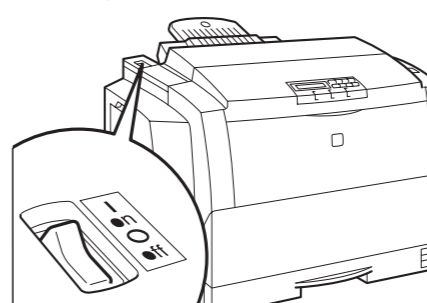

4 Load paper into the tray with the print side up.

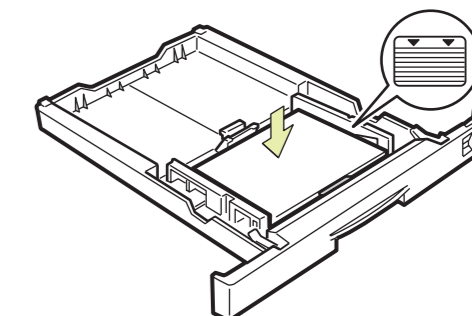

Important

- Make sure that the stack of paper is no higher than the limit mark (▼) inside the tray.
- Make sure the paper fits under the back paper guide.
- Do not load different kinds of paper in the tray.

5 Adjust the paper size dial to match the size and feed direction of the paper in the paper tray.

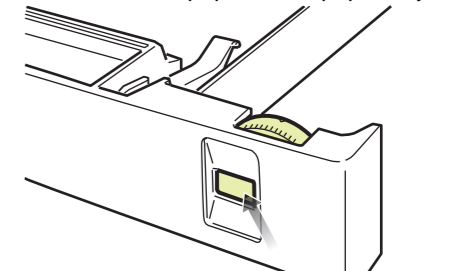

6 Slide the paper tray completely into the printer.

Important

- Be sure to insert the paper tray completely. Otherwise, paper misfeeds might occur, or the front cover might touch the paper tray.

7 Insert the output tray extender into the output tray.

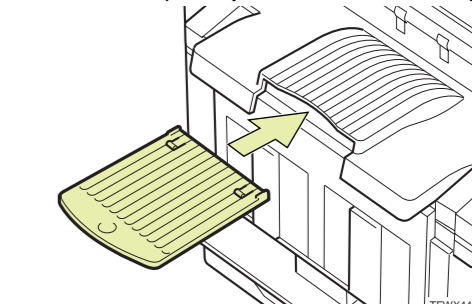

2 Attach the power cord to the socket on the back side of the printer.

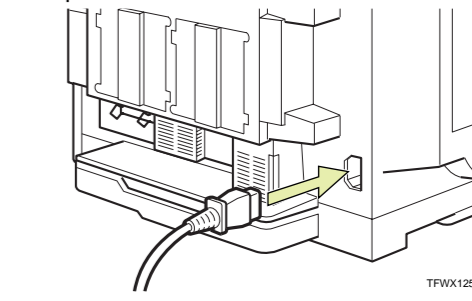

3 Insert the plug of the power cord securely into the wall socket.

7

PREPARING THE TONER CARTRIDGES

Warning

- Do not incinerate spilled toner or used toner. Toner dust might ignite when exposed to an open flame.
- Disposal can take place at our authorized dealer or at an appropriate collection site.
- If you dispose of the used toner containers yourself, dispose of them according to your local regulations.

Caution

- Do not eat or swallow toner.
- Keep toner (used or unused) and toner cartridges out of reach of children.
- Our products are engineered to meet the highest standards of quality and functionality. When purchasing expendable supplies, we recommend using only those provided by an authorized dealer.
- When removing misfed paper, do not touch the fusing section because it could be very hot.

Toner cartridges have already been installed in the machine at the factory.

Follow the instructions below to remove the tape from each cartridge and prepare them for use with this machine.

Note

- Prepare the cartridges in the following order:
1. Yellow, 2. Cyan, 3. Magenta, 4. Black.

1 Turn on the printer's power switch.

The following message appears on the panel display.

IPDL-C
Warming Up

The following message appears on the panel display. It requires about 4 minutes.

Remove the Tape
Yellow Toner

2 Open the left cover.

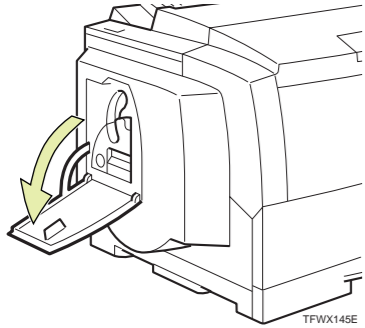

3 Slide the lock lever up.

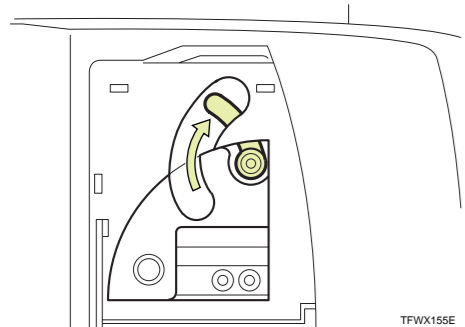

4 Carefully pull out the toner cartridge.

- Hold the grip of the toner cartridge, and slide it out until you can see the green tape.
- With your hand under the green tape, remove the toner cartridge carefully as shown in the illustration.

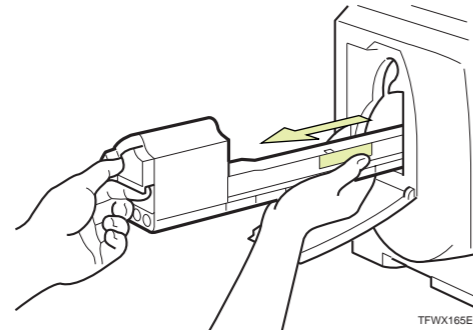

5 Hold the new toner cartridge and shake it with a horizontal motion, about 10 times, as shown in the illustration.

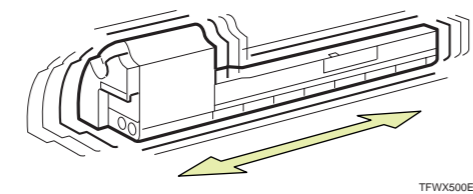

Important

- If the toner cartridge is not shaken enough, toner might not be evenly distributed in the cartridge. In this case, the print quality might be reduced.

6 Slide the new toner cartridge into the printer.

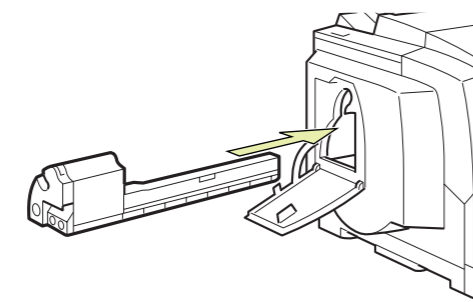

Note

- Do not push the toner cartridge with force.

7 Return the lock lever to its original position.

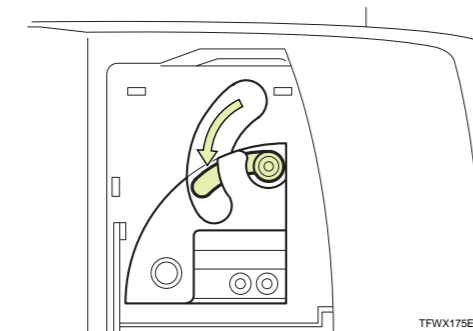

8 Pull the tape out as shown in the illustration.

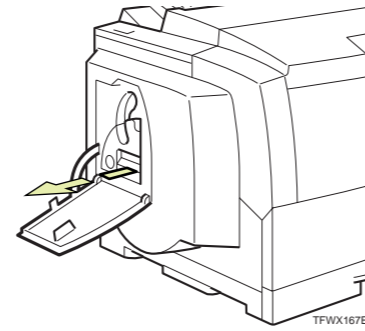

9 Close the left cover.

At this time, the message changes on the panel display.
The toner cartridge will automatically rotate to the next color.

10 Repeat steps 2 to 9 for each color toner cartridge.

If the following message appears on the panel display, the printer is warming up. It requires about 8 minutes to warm up.

Please Wait
Approx 8min(s)

Important

- Do not open the front cover and turn off the power until the machine is ready. If you do, the printer may be resetting.

The following message appears on the panel display. This completes the toner cartridges installation.

IPDL-C
Ready

8

PRINTING THE TEST PAGE

You can check if the printer works properly by printing a test page (configuration page). However, you cannot check the connection between the printer and your computer by printing the test page.

1 Press the Menu key.

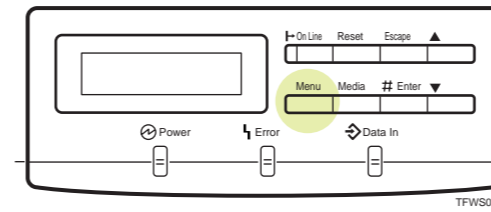

The following message appears on the panel display.

<Menu>
IPDL-C Menu

2 Use the ▲ and ▼ keys to display "List Print", and then press the Enter key.

<Menu>
List Print

The following message appears on the panel display.

<List Print>
Config. Page

3 Confirm that "Config. Page" is on the display, and press the Enter key.

The following message appears on the panel display.

<Config. Page>
Press # key

4 Press the Enter key.

In a short time, the test printing will start.

Printing...
Config. Page

Important

- If you cannot complete the test printing correctly, see if an error message appears on the panel display. For more information about error messages, see "Troubleshooting" in the "Operating Instructions".

5 Press the On Line key.

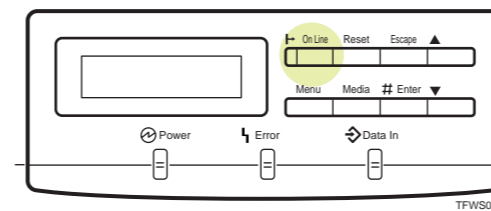

6 Turn off the printer's power switch.

9

CONNECTING THE PRINTER TO A COMPUTER

Connect the printer to your computer using a parallel interface cable.

Important

- The parallel interface cable is not provided with the printer. It is your responsibility to provide the interface cable appropriate for the computer that you are using.
- The printer's parallel connection is a standard bi-directional interface. It requires a standard 36-pin parallel cable compliant with IEEE1284 and a parallel port on your computer.
- To avoid electrical interference, use a shielded cable.

Note

- Do not use a parallel cable more than 2.5 meters (8.2 feet) long.

1 Make sure that the printer's power switch is turned off. If it is on, turn it off.

2 Turn your computer off.

3 Attach the interface cable to the interface connector of the printer. Secure the cable with the metal fittings as shown in the illustration.

Important

- Rating voltage of the parallel interface connector for the computer: Max. DC 5V.

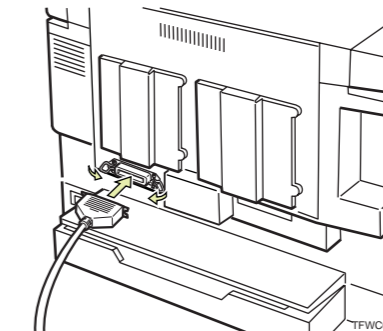

4 Attach the other end of the interface cable to the interface connector of the computer. Secure the cable.

10

SETTING UP FOR PRINTING

Printing requires installation of a printer driver for your operating system.

Reference

- See "Installing the IPDL-C Printer Driver" in the "Operating Instructions".
- If you want to install options, see "Installing Options" in the "Operating Instructions".